

Custom Designed Material Handling Solutions



## Model 5500 / 5600 Sheetlifter Operating & Maintenance Instructions

### Operating Instruction I

Load must be turned broadside (90°) to direction of crane travel to prevent plates from moving or sliding free. **Warning! Failure to follow this instruction can result in serious bodily injury or death.**

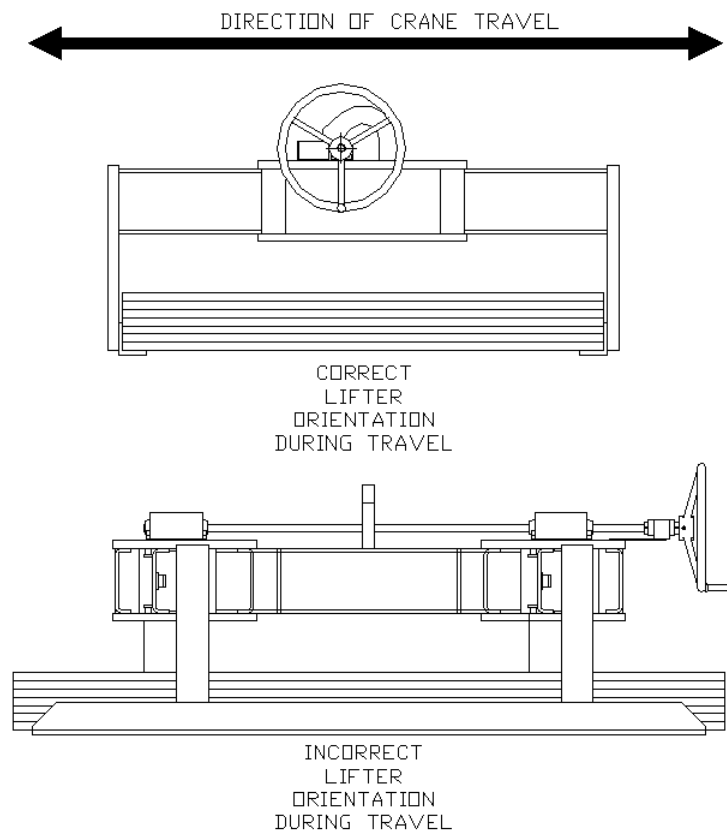



### Operating Instruction II

Grab must be loaded evenly and operated in a level condition. **Warning! Failure to follow this instruction can result in serious bodily injury or death.**

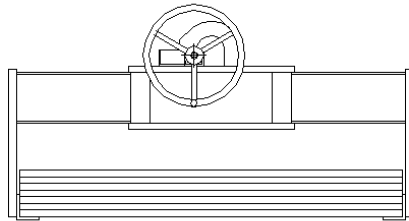
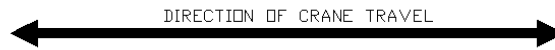

CORRECT  
LOADING AND  
ORIENTATION  
DURING TRAVEL

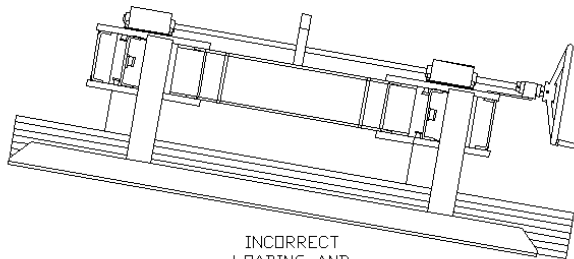

INCORRECT  
LOADING AND  
ORIENTATION  
DURING TRAVEL

Custom Designed Material Handling Solutions



### Operating Instruction III

When handling a limited number of sheets always obtain longitudinal bending to avoid potentially dropping the load. **Warning! Failure to follow this instruction can result in serious bodily injury or death.**

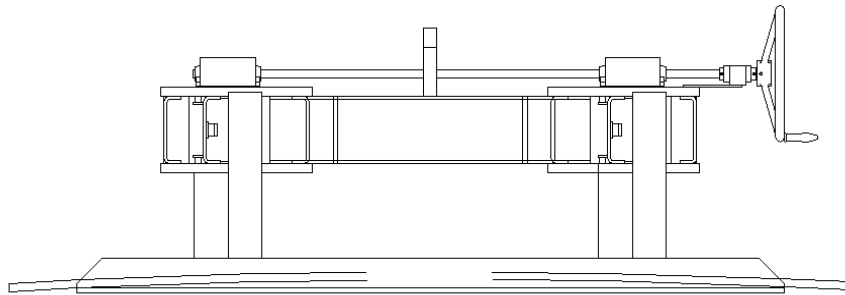

CORRECT  
OBTAIN  
THIS  
(LONGITUDINAL BENDING)

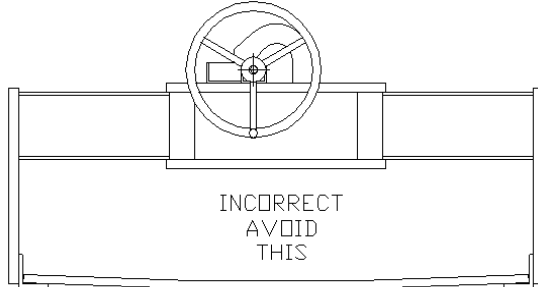

INCORRECT  
AVOID  
THIS

### Maintenance - Lubrication

- Coat teeth of rack and pinion every two months with open gear grease Multi-Service No.2.
- Lubricate worm, worm gear, slides and slide ways every two months with Molykote Type G or equivalent.
- Lubricate bronze bushings and thrust bearings with SAE 30 oil when required.

### Maintenance - Inspection

#### **Inspect unit daily for the following:**

- Structural fatigue. Inspect the general frame, bail area, vertical members and drop legs. Contact Bushman AvonTec if any signs of fatigue are detected.
- General wear
- Loose bolts
- Damaged labels (Refer to: Identification & Safety Standards document)
- Bail wear. Inspect saddle portion of bail (area that contacts the hook) for wear. **Do not use if the top section (Dimension “A”) measures less than 80%**, or 4/5 of original dimension. Refer to Certified Dimensional drawing for the dimensional value of “A”.

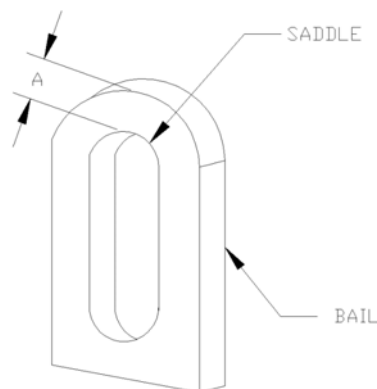

#### **Inspect unit every six months for the following:**

- Check worm and worm gear for wear.
- Check rack & pinion for wear.
- On model 5600 check roller chains and sprockets, replace if needed